



Gas detection just got personal



Coloured 'rubber boot'
for multi-site or
multi-application working
(7 colours available)

PS200 Series

Part of the Personal Surveyor range



- Simple 1-button operation
- Any combination of (LEL/O₂/CO/H₂S)
- Audible, visual and vibrating alarms
- Fully certified
- Internal pump (optional)
- Lightweight
- Sensor integrity checking
- Robust construction
- Ease of maintenance

Auto Bump & Calibration Station

- Simple user interface
- Full bump, calibration and charging options
- Bump/calibration results storage
- Stand-alone, PC or ethernet options
- Robust construction

Detection, Protection, Innovation



GMI. CONFIDENCE WHERE SAFETY IS CRITICAL. Gas Measurement Instruments designs, manufactures and markets a wide range of the highest quality proven personal portable and fixed gas monitoring systems. GMI is an international brand with a worldwide network of distributors and dedicated service centers ensuring fast and effective turnaround on instrument calibration and repair. Our uncompromising engineering excellence, established in over half a century of leadership, enables us to meet the exacting demands of industries where safety is critical. By building and maintaining strong relationships with our customers, GMI understands the unique challenges of the diverse markets we serve. Today, our proud heritage of pioneering gas leak monitors and detectors is shaping the future of GMI.



PS200 Series



The PS200 Series detects all possible combinations of LEL, O₂, CO, H₂S, including single gas detection. In addition to displaying all gas readings simultaneously, the user can also initiate a manual bump test anytime.

The PS200 accessory pack includes the following as standard: USB Charging/Comms Cable, Universal Power Plug, User CD-ROM, Quick Operating Instructions. Tubing (3m) complete with a Quick Connector is also supplied as standard with pumped instruments.

Features

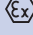

TECHNICAL SPECIFICATION

Size:	121 x 59 x 32mm (4.8" x 2.3" x 1.3")
Weight:	230g (8oz) with pump 215g (7.6oz) without pump
Temperature:	-20°C to +50°C (-4°F to 122°F)
Humidity:	0 to 95% R.H non-condensing
Alarms:	Highly visible flashing LED, piercing >90dB audible Green and red LCD backlight display
Display:	Green and red LCD backlight display
Datalogging:	Timed: 24 hours of timed logs at 1 log per minute Session: Minimum of 180 logs Calibration: Minimum of 8 calibration logs Bump Logs: Minimum of 180 logs
Battery:	Lithium Ion rechargeable battery Run Time > 14 hrs (diffusion) Charging Time < 4 hrs
Enclosure:	High impact rubberized polycarbonate case
Drop Test:	3m (10ft)
IP Rating:	IP67 (Dust-tight and waterproof to 1m)
Response Times (T₉₀):	LEL = 10 secs (IEC 60079-29-1) O ₂ = 10 secs (BSEN 50 104) CO = 25 secs H ₂ S = 35 secs
Approvals:	IEC Ex ia d IIC T4 Gb ATEX Ex II 2 G Ex ia d IIC T4   CSA Class 1 Div 1 Groups A,B,C,D, T4 Class 1, Zone 1 EX ia d IIC T4  MED (0038/YY) - Module B & E CE 0518
Warranty:	2 years as standard

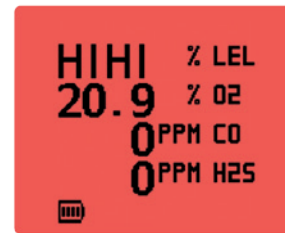

Red display in alarm conditions



Configurable calibration options



Configurable bump options

Automatic Bump Testing and Calibration

To complement the Personal Surveyor product line, GMI has developed a compact, robust and easy to use Auto Bump & Calibration Station that can provide full bump and calibration options. Data transfer is facilitated using a USB memory stick with Standalone software that is simple to set up and customise based on end users' specifications. Standalone, PC, and ethernet versions are available.



Ethernet

Same as PC except multiple units can be connected to a network allowing one PC to control and receive data.

Datalogging

Datalogging is a standard feature of all PS200 Series instruments and the internal memory can hold up to 180 bump test and session logs, 8 calibration logs and 24hrs of timed logs at 1 log per minute.

Simple data extraction from instrument to PC using USB cable supplied. Upgrade your package to include PC datalogging software.

Standalone

By adding the Auto Bump & Calibration Station to your PS200 package, data can be easily retrieved using specific software in a user-friendly time logged format. This gives you the ability to create and print your personalised calibration certificate.

PC

Allows easy configuration (bump test or calibration) of Auto Bump & Calibration Station and allows all results to be automatically stored to a database on the PC. The stored results can be easily viewed and calibration certificates produced. The history of all results can be easily viewed and reports of instruments can be easily compiled.

AUTO BUMP & CALIBRATION STATION TECHNICAL SPECIFICATION

Size:	200 x 140 x 135mm (7.9" x 5.5" x 5.3")
Weight:	1.2kg (43oz)
Interfaces:	Standalone /USB /Ethernet
LED Indicators:	Power (Green) /Testing (Yellow) /Pass (Green) / Fail (Red)
Testing Time:	Bump Test 60 secs Calibration Test 90 secs
Data Storage:	>6000 Bump & Calibration results
Power Supply:	12V dc, 2A
Operating Temperature:	-10°C to 40°C (14°F to 104°F)
Gas Ports:	3 (Air, Combi Gas & Exhaust) Contact GMI for other combinations

SENSOR SPECIFICATIONS

GAS	RANGES	INCREMENTS	SENSOR TYPE
LEL	0-100% LEL	1% LEL	Catalytic Bead
O ₂	0-25%	0.1%	Electrochemical
CO	0-1000ppm	1ppm	Electrochemical
H ₂ S	0-100ppm	1ppm	Electrochemical

PS200 Series

Simple User Maintenance

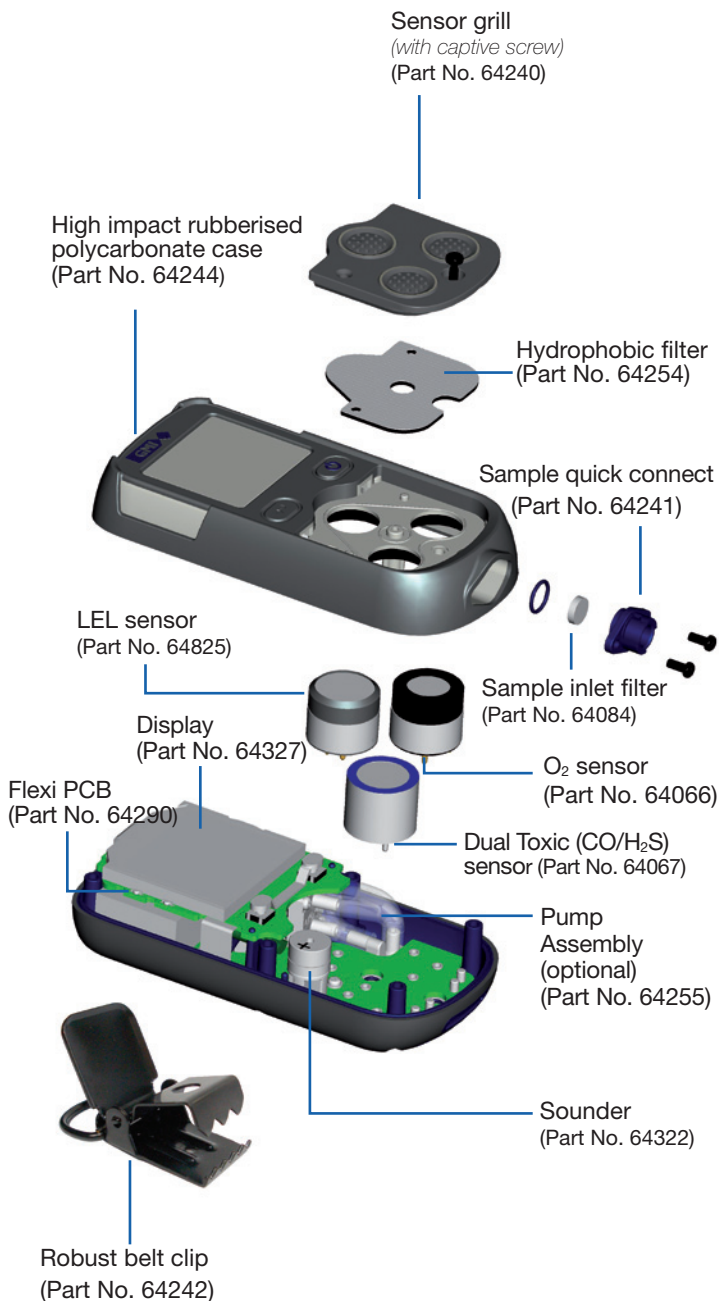

ORDERING INFORMATION AND ACCESSORIES

Accessories supplied with the instrument	
64260	USB Charging / Comms Cable
64247	Universal Power Plug (Mains – USB)
64190	User CD-ROM (Incl. Handbook)
64172	Quick Operating Instructions
64118	3m. PVC sample line with Quick Connector (pumped only)

RECOMMENDED SPARE PARTS

64254	Hydrophobic Filter
64084	Sample Inlet Filter
64825C	LEL sensor
64066	O ₂ sensor
64067	Dual Toxic CO/H ₂ S Sensor
64176	CO sensor
64128	H ₂ S sensor
64255	Pump Assembly

ADDITIONAL ACCESSORIES

64303	Rubber Boot (Colour options:- black, grey, yellow, red, orange, blue, green)
66123	Hand Aspirator
66478	Hand Aspirator (c/w 10 ft. tubing)
66112	Sample Line Extender
66485	In-Line Hydrophobic Filter Assy
66545	Ball Float
64100	Rugged Carry Case

Charging Accessories

64248	In-Vehicle Charging Adaptor (12V/24V – USB)
64138	5 Way Multi-Charger

Automatic Bump & Calibration

64052	Auto Bump & Calibration Station (6mm. fittings & incl. PSU and USB stick with Standalone software)
64052Q	Auto Bump & Calibration Station (1/4 in. fittings & incl. PSU and USB stick with Standalone software)
99553	flexiCal Plus software for PC
99118	Demand Flow Regulator
64265	Tubing with 6mm Push Fit Connector

Manual Bump & Field Calibration Kit

64051	Manual Bump Kit (no power required) (c/w Combi Test Gas 99146, Direct Flow Regulator, tubing & sample line connector)
-------	---

Gas Kits for Auto Bump & Calibration Station

99146	Combi Test Gas Cylinder (2.5% CH ₄ , 500ppm CO, 50ppm H ₂ S, 18% O ₂ , balance N ₂)
64060	Test Gas Kit (6mm fittings) (Combi Test Gas 99146, Demand Flow Regulator 99118 c/w 6mm tubing)
64060Q	Test Gas Kit (1/4 in Fittings) (Combi Test Gas 99146, Demand Flow Regulator part no. 99118 c/w 1/4" tubing)

Software

64197	Data downloading CD-ROM (c/w Handbook)
64184	Auto Bump & Calibration Station USB Flash Drive (c/w Handbook)

Documentation

64193	Configuration & Field Calibration Handbook (CD-ROM)
-------	---



© Copyright 2011 Gas Measurement Instruments Ltd

PS200 product brochure Part No. 64170

Issue 3 Feb 2012

GMI Headquarters

Inchinnan Business Park
Renfrew
PA4 9RG
Scotland
Tel: +44 (0) 141 812 3211
Fax: +44 (0) 141 812 7820
sales@gmiuk.com
www.gmiuk.com

Service and Calibration - UK

25 Cochran Close
Crownhill
Milton Keynes
MK8 0AJ
Tel: +44 (0) 1908 568 867
Fax: +44 (0) 1908 261 056
service@gmiuk.com
www.gmiuk.com

Service and Sales - USA

4055 Technology Forest Blvd.
The Woodlands, TX 77381
Tel: (713) 559-9290
Toll free: (877) 421-5315
Fax: (281) 292-2860
sales@detcon.com

Distributed by:

As an ISO 9001 approved company, Gas Measurement Instruments quality assurance programmes demand the continuous assessment and improvement of all GMI products. Information in this leaflet could thus change without notification and does not constitute a product specification. Please contact GMI or their representative if you require more details.